

Telsa™ 10

RECHARGEABLE CORDLESS CLEANER

USER MANUAL



EV10

 **KOKIDO**®
Pool Product Innovations
Table Of Contents

PARTS DIAGRAM

P.2

SAFETY WARNINGS & INSTRUCTIONS	P.3
GETTING STARTED	P.5
Charging The Battery	P.5
Set-Up Before Use	P.6
Pole connector assembly	P.6
Brush assembly	P.7
Pole assembly	P.7
Telescopic pole (not included) assembly	P.7
OPERATION	P.8
EMPTYING THE FILTER	P.9
MAINTENANCE & STORAGE	P.10
BATTERY DISPOSAL	P.10
How to remove the battery pack	P.11
TROUBLESHOOTING	P.12

Remark: Product/parts photos in this manual are for demonstration only.

Product/parts in photos may vary with the model purchased.

PARTS DIAGRAM

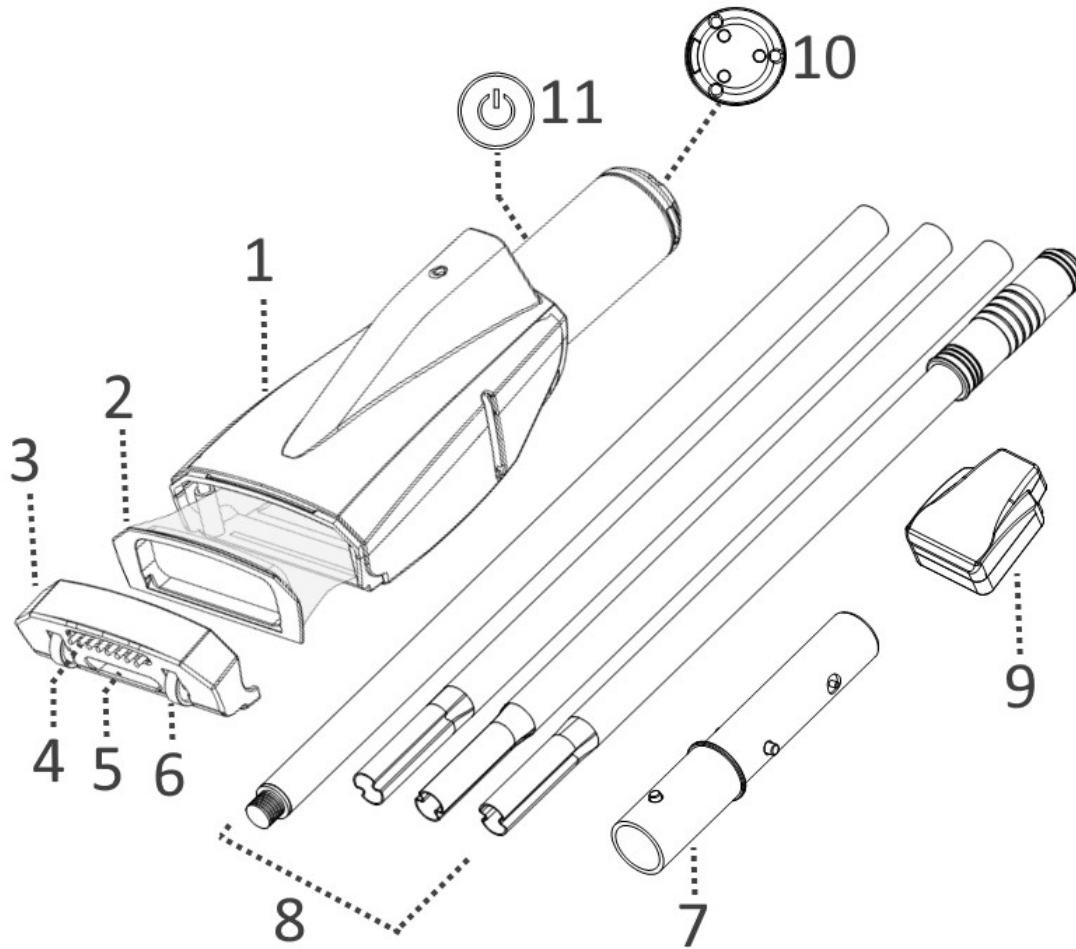

- | | | | |
|---|-------------|----|------------------------|
| 1 | Main body | 7 | Pole connector |
| 2 | Filter bag | 8 | Pole sections |
| 3 | Front cover | 9 | Charger base |
| 4 | Brush | 10 | Charging contact plate |
| 5 | Nozzle flap | 11 | Power ON/OFF button |
| 6 | Wheel | | |

Battery: Rechargeable Li-ion battery pack, 2000mAH, 7.4V, 14.8Wh

Charging voltage : 8.4V DC, 1.0 A

Motor: 7.2V DC

SAFETY WARNINGS & INSTRUCTIONS

Read and follow all instructions in this manual and on the equipment. Failure to do so could result in severe or fatal injuries.

WARNING!

- This is not a TOY. Children should be kept out of reach from this pool vacuum and its accessories.
- Never allow children to operate this product.
- This pool vacuum is not intended for use by someone with reduced physical, sensory or mental capabilities, or a lack of experience and knowledge unless they have been given instructions concerning the appliance and are under supervision of the person responsible for their safety.
- Make sure the pool vacuum is fully immersed in the water before operation. The minimum water level required to operate the device must reach above the power button of the pool vacuum when it is held in a vertical position. Operating the pool vacuum when it is not immersed in the water correctly could damage the unit and void the warranty as a result.
- Maximum operating depth in water is 2 meters (6.5 ft).
- Maximum water temperature: 5°C (41°F) –35°C (95°F) - DO NOT use power extension cords.
- Connect the external adaptor to a power source through a residential current device (RCD). If in doubt, consult a qualified professional electrician.
- Do not use this pool vacuum if any damage is detected.
- Replace damaged parts as soon as possible. Only use parts certified by the distributor or manufacturer.
- Turn off the power, disconnect the external adaptor from the power source, and unplug the external adaptor from the charging base before detaching the pool vacuum from the charging base.
- Disconnect the pool vacuum from the supply mains prior to carrying out user maintenance such as cleaning the filter.
- Detach the pool vacuum from the charging base and make sure the pool vacuum is OFF before servicing the product.
- Battery installed is a rechargeable Li-ion battery pack. Never attempt to replace the battery pack.
- The pool vacuum is only to be used with the external adaptor delivered with this product.
- You should not operate this pool vacuum when people/pets are present in the water.
- DO NOT use this pool vacuum without an intact filter bag in place, as your warranty will be voided as a result.
- Suction entrapment hazard: This pool vacuum generates suction. Do not allow hair, body, or any loose parts of your clothing to make contact with the suction hole of the pool vacuum during its operation.
- Never insert body parts, clothing or other objects into the openings and moving parts of the pool vacuum.
- DO NOT use this pool vacuum to pick up any toxic substance, flammable or combustible liquids such as gasoline, or in the presence of explosive or flammable fumes.
- Never attempt in any way to disassemble this pool vacuum.
- Under no circumstances should you attempt to disassemble the pool vacuum and replace the impeller, motor, and battery by yourself. - Never insert any object to touch the impeller.
- External adaptor and charging base:
 - For indoor use only.
 - Never use the external adaptor and charging base for anything other than charging the battery of the pool vacuum that is supplied in the same pack. The

external adaptor and charging base should not be used outdoors, nor exposed to rain, humidity, any liquid or heat.

Keep the external adaptor and charging base out of reach of children.

Never use the external adaptor and charging base if any damage is detected.

DO NOT handle the external adaptor and charging base with wet hands. DO NOT handle the pool vacuum, external adaptor, and charging base while charging with wet hands and without shoes.

Keep the external adaptor disconnected from power when it is not in use.

Never attempt to open the external adaptor and charging base.

If the supply cord is damaged, it must be replaced by the manufacturer, its service agent or an equally-qualified person in order to prevent hazards of any kind.

Make sure the pool vacuum and the charging base are completely dry before charging.

CAUTION!

- This pool vacuum is designed for underwater use only; it is not an all-purpose vacuum cleaner. DO NOT attempt to use it to clean anything other than your pool / spa.
- Use only original accessories delivered with this product.
- DO NOT use this pool vacuum right after pool-shocking. It is recommended to leave the pool circulating for at least 24-48 hours.
- It is not recommended to use this pool vacuum with another pool vacuum/cleaner simultaneously.
- Avoid picking up hard, sharp objects with this product. They may damage the pool vacuum and filter.
- Exercise caution when cleaning pool stairs.
- Only use the charging base for its intended purpose as outlined in this manual.
- To avoid damaging the external adaptor and the cord, do not carry the pool vacuum by the cord or pull the cord to disconnect it from the power source and product.
- Charge the pool vacuum indoor in a clean, dry area with good ventilation and an ambient temperature between 5°C (41°F) and 35°C (95°F).
- DO NOT leave the pool vacuum charged for over 20 hours.
- If the pool vacuum will not be used for an extended period, detach it from the charging base and use a damp cloth to clean and dry the pool vacuum and accessories. Make sure to charge the pool vacuum completely before it is stored. Store in a well-ventilated area away from sunlight, heat, ignition sources, pool chemicals, and children. Never leave the pool vacuum plugged in for long-term storage. Recharge the pool vacuum every three months.

Above warnings and cautions are not intended to incorporate all possible instances for risks and / or severe injuries. Pool / spa owners should always exercise extra caution and common sense when utilizing the product.

GETTING STARTED

IMPORTANT NOTE: Fully charge the pool vacuum before using it for the first time.

Charging the battery

WARNING!

Charging must be done indoors, in a well-ventilated area away from sunlight, children, heat, ignition sources, and with an ambient temperature between 5°C (41°F) and 35°C (95°F).

Never use the external adaptor and charging base if any damage is detected.

Use only the original external adaptor provided.

Make sure the pool vacuum and the charging base are clean and dry before set-up.

1. Place the unit on a flat surface. Insert and slide the hook of the charging base into the notch on the end of the main body unit it stops. Make sure the contact plates are properly in contact.

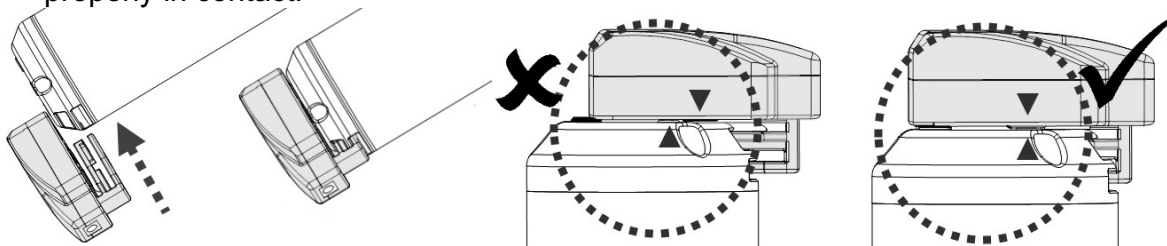

2. Plug the female jack of the external adaptor into the charging port at the end of the charging base.

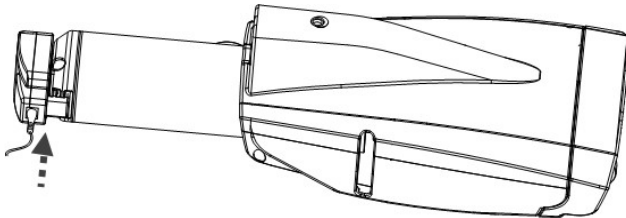

WARNING!

DO NOT handle the pool vacuum, external adaptor and charging base while it is charging with wet hands and without shoes.

Connect the external adaptor to the power source through a residential current device (RCD).

Charge the pool vacuum with the original external adaptor provided.

DO NOT use power extension cords.

Fully charge the battery before first use.

Charging must be done indoors, in a dry & well-ventilated area away from sunlight, children, heat, ignition sources, and with an ambient temperature between 5°C (41°F) and 35°C (95°F).

Always disconnect the external adaptor from the power source when charging is complete.

Do not leave the pool vacuum in charge for over 20 hours.

Immediately turn the power off and disconnect the external adaptor from the power source if you detect any of the following conditions:

- Offensive or unusual odor
- Excessive heat
- Deformation, cracks, leaks
- Smoke

1. Make sure that the pool vacuum is turned off prior to charging.

2. Connect the external adaptor to the power source. Once the pool vacuum begins charging, the indicator light on the external adaptor will turn red. Normally, it takes about 4- 5 hours to reach a full charge. The indicator light will turn green when the pool vacuum is almost fully charged.

Note: If the motor is generating noise, immediately turn off the device by pressing the ON/OFF button. Otherwise, it could potentially lead to failure of the shaft seals / motor, and the warranty will be voided as a result.

Note: Charge the pool vacuum completely (about 4-5 hours) prior to the first use.

3. When charging is complete, disconnect the external adaptor from the power source and unplug the jack from the charging base. 4. Detach the charger base from the pool vacuum.

Normally, the pool vacuum can be operated up to 45 minutes on a full charge (charged for 4-5 hours)

Note: Clean the filter regularly. Too much debris inside the filter will increase burden to the motor operation and then shorten the operating duration.

FACT: Rechargeable lithium-Ion battery is classified as a consumable item. It has a limited life and will gradually lose its capacity to hold a charge. Therefore, running time of the pool vacuum will gradually reduce through repeated charging and discharging in operation.

NOTE: Let the pool vacuum rest for 30 to 40 minutes before charging it again.

Set-Up Before Use

Pole connector assembly

Press down the side pins of the connector and insert it inside the main body. Turn the connector in either direction until the pin is secured in the hole, as shown in the diagram.

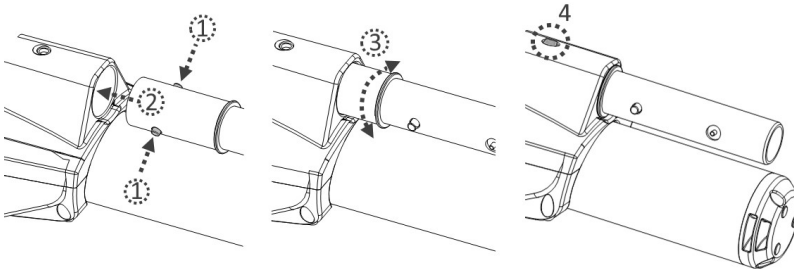

Brush assembly

Align and push the brush into the notch on the front cover.

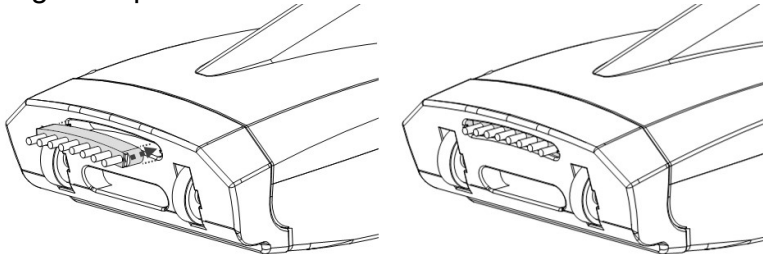

Pole assembly

Select the tube section with a threaded tip at the end. Insert and the threaded tip of the pole section inside the pole connector and turn it clockwise to screw it inside. Finish the assembly by inserting the grooved ends of the following section tubes in the round ends of the remaining section tubes. The section with the grip is the last section to be assembled.

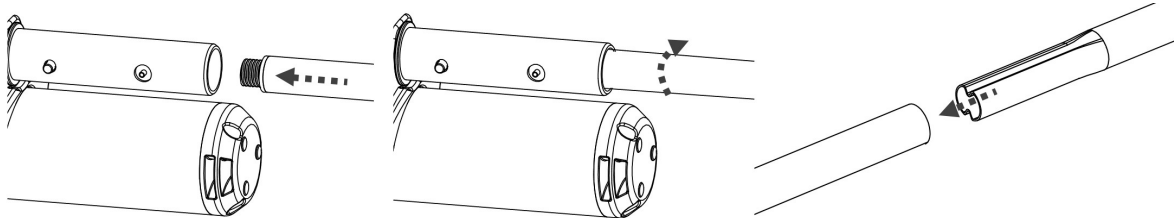

Telescopic pole assembly

Note: V-clip is installed inside the pole connector for the purpose of securing the telescopic pole (not included) in position. Slide the telescopic pole onto the pole connector. Press on the side pins of the connector and slide the telescopic pole further until the pins are secured inside the holes of the pole.

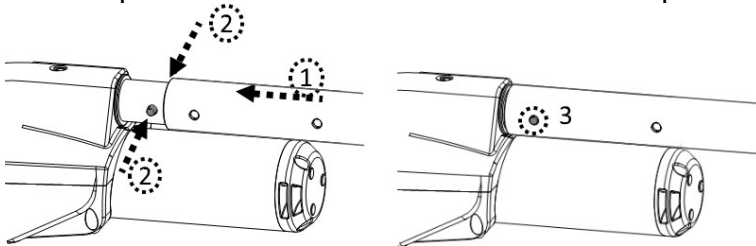

To release the telescopic pole, press down the side tabs simultaneously and pull out the pole.

OPERATION

WARNING!

Do not use the pool vacuum if any damage is detected.

Oil stain could occur due to possible leakage of lubricants applied to the O-ring.

Do not operate this pool vacuum if there are people/pets present in the water.

Make sure the pool vacuum is fully immersed in the water before initiating operation.

The minimum water level required to operate the device must reach above the power button of the pool vacuum when it is held in a vertical position. Operating the pool vacuum when not immersed in the water correctly can damage the unit and the warranty will be voided as a result.

Maximum operating depth in water is 2 meters (6.5 ft).

Maximum water temperature: 5°C (41°F) –35°C (95°F)

DO NOT use the pool vacuum without an intact filter bag in place. Using your pool vacuum without an intact filter bag in place will VOID your warranty.

Suction entrapment hazard: This pool vacuum generates suction. Do not allow hair, body or any loose parts of your clothing to make contact with the suction mouth of the pool vacuum during its operation.

Never insert body parts, clothing or other objects into the openings and moving parts.

DO NOT use this pool vacuum to pick up any toxic substance, flammable or combustible liquids such as gasoline, or operate in the presence of explosive or flammable fumes.

DO NOT cover the side slot of the cleaner body during operation. The impeller/motor may be damaged as a result.

Never insert any object to touch the impeller.

CAUTION

Use only original accessories delivered with this product.

DO NOT use this pool vacuum immediately after pool-shocking. It is recommended to leave the pool circulating for at least 24-48 hours.

It is not recommended to use this pool vacuum with another pool vacuum/cleaner simultaneously.

DO NOT leave the pool vacuum in the water when it is not in use or when battery is low as water leakage may occur.

- 1) Bring your pool vacuum to the side of your pool / spa. Immerse the pool vacuum in water and press the power button to initiate operation.

CAUTION! Make sure the pool vacuum is always facing downwards when it is placed into the pool. Otherwise it may bend the pole connector and damage it during the process.

- 2) To remove the pool vacuum from the pool / spa, lift the pool vacuum while pointing it downwards in order to allow water to escape from the outlet valve. Water is going to escape via the handle / pole connector and draining holes inside the handle chamber on the rear body.

CAUTION! Make sure the pool vacuum is always facing downwards when it is removed from the pool. Otherwise, the pole connector may be bent and damage the pool vacuum in the process.

- 3) Rinse the pool vacuum with fresh water after every use. DO NOT use any detergent.

EMPTYING THE FILTER

WARNING! Using the pool vacuum without a filter bag in place will **VOID** your warranty.

In order to maximize the cleaning efficiency, be sure to clean the filter bag before and after each use.

CAUTION! If the pool vacuum is charging, disconnect the external adaptor from the power source and detach the pool vacuum from the charger base.

Emptying filter bag

1. Place the pool vacuum on a stable surface.
2. Hold the front cover and pull on the rib (on cover bottom) to detach the front cover from the main body. Take the filter bag out of the cleaner.

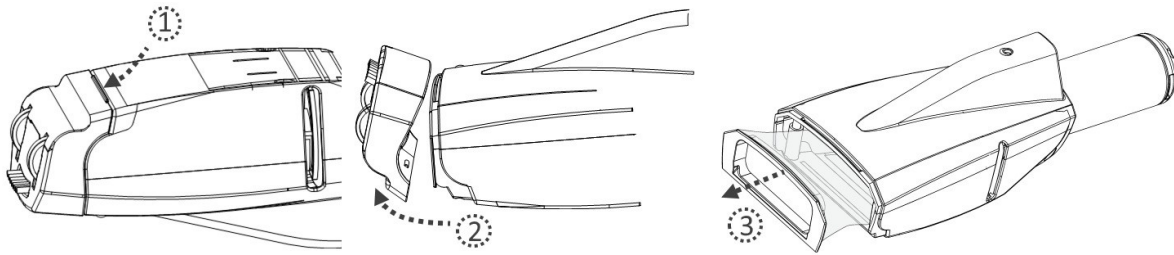

CAUTION! Replace the damaged filter bag immediately before the next operation.

3. Clean out the debris and rinse the filter bag with splashing water. If brushing is deemed necessary, use only a soft brush to clean it gently and carefully.
4. Reverse the previous steps to re-assemble the filter bag and then the front cover. Make sure the front cover is well secured on the main opening body and that no gaps are visible before the next operation.

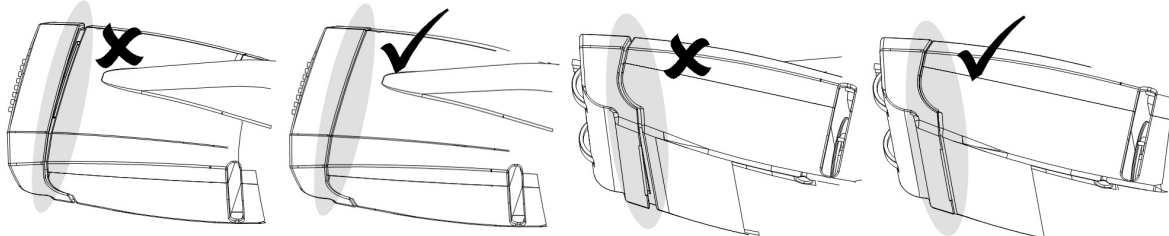

MAINTENANCE & STORAGE

NOTE:

1. Battery discharges on its own during storage. Make sure to fully-charge the pool vacuum before storage.
2. You must re-charge the battery at least once every three months when it is not in use. Unplug the external adaptor from socket and then unplug the adapter jack from the charging base.

Detach accessories from the pool vacuum. If necessary, rinse the pool vacuum and accessories with fresh water. **DO NOT** use detergent.

Make sure to drain the water from the unit, handle and pole connector.

Use a damp cloth to clean and dry the pool vacuum and its accessories.

Store them in a well-ventilated area away from the sunlight, children, heat, ignition sources, and pool chemicals. Ambient temperature for storage should be 10°C – 25°C (50°F – 77°F). **NOTE:** A higher temperature may reduce the battery life during storage.

WARNING!

- Never attempt in any way to disassemble the pool vacuum.
- Under no circumstances should you attempt to disassemble the pool vacuum and replace the impeller, motor and battery by yourself.

CAUTION!

Excessive heat can damage the battery and reduce its lifespan as a result.

The battery supplied with your pool vacuum lasts for about 300 charging cycles (with proper charging and operation). Replace your pool vacuum with a new battery if the following happens. Consult your dealer regarding battery replacement.

- Battery appears damaged or will not charge fully.

- Battery operation time is noticeably reduced. Observe and note down the run times of operation of the first few times (on a full charge). Use these run times as a reference point to compare run times with older batteries.

The battery must be removed from the pool vacuum before it is scrapped. The pool vacuum must be disconnected from the supply mains when removing the battery

The battery is to be disposed safely and according to local ordinances or regulations.

NOTE: Incorrect maintenance may reduce the battery life and affect its capacity as a result.

BATTERY DISPOSAL

Your pool vacuum battery is a maintenance-free rechargeable lithium-ion battery pack, which must be disposed properly. Recycling is required; please contact your local authority for information.

WARNING!

Never attempt to disassemble a battery pack

Remove all personal items such as rings, bracelets, necklaces and watches when the battery pack is unwired from the pool vacuum.

A battery can produce a short circuit current high enough to weld a ring (or similar item) to metal, causing a severe burn in the process.

Wear complete eye protection, gloves and protective clothing when the battery pack is being removed.

Avoid touching the wires altogether and avoid allowing them to make contact with any metal items, which could cause sparking and/or short circuit the battery. Never smoke or allow a spark or flame in the vicinity of the battery or the pool vacuum.

Do not expose the battery to fire or intense heat as this may result in an explosion.

CAUTION!

If a battery leak occurs, avoid contact with the leaking fluids and place the damaged battery in a plastic bag.

- If leaking fluids come in contact with skin and clothing, wash immediately with plenty of soap and water.
- If leaking fluids come in contact with eyes, immediately flush eyes with cool running water for at least 15 minutes and do not rub them. Seek medical attention as soon as possible.

How to remove the battery pack

Recommended tools (not included): Philips screwdriver

1. Use the screwdriver to unscrew 3 screws on the rear plate and then detach it from the body. Pull out the battery pack to gain access to the battery pack connector.



2. To detach the battery pack, press the clip on the connector and pull it out.
 NOTE: Wrap the connector immediately with insulating tape in order to avoid short circuit caused by contact of both wire terminals.

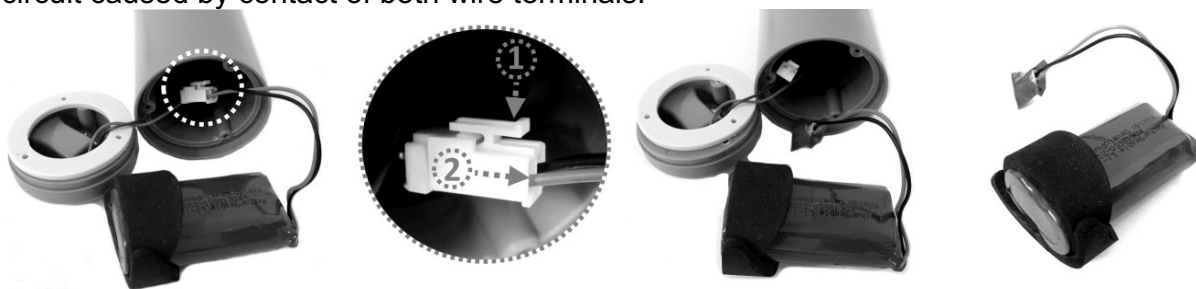



TROUBLESHOOTING

Problem	Possible Cause	Solution
Pool vacuum does not capture the debris	Battery is running out	Charge the battery again.
	Impeller is jammed	Power off the pool vacuum and visually check the gap in middle of the pool vacuum to see if the impeller is jammed by larger debris. If possible, use a small tool to remove it with intensive care & caution. If necessary, contact your dealer for further instructions. WARNING! Make sure the pool vacuum is powered off when the unit is being serviced.
	Impeller is broken	Contact your dealer for impeller replacement.
	Filter is full	Clean the filter
Debris escapes from the filter	Suction nozzle flap is broken	Suction nozzle flap works like a door to prevent the debris from escaping from the filter. Contact dealer for replacement part and instruction.
Debris goes outside the filter bag	Filter bag is damaged.	Replace with a new filter bag.
Pole connector cannot be secured in assembly	Side pin is broken	Replace with a new pole connector.
Pool vacuum cannot be charged / recharged	Battery is damaged	Contact dealer for battery replacement. WARNING! DO NOT open the pool vacuum and replace the battery by yourself. This could result in severe or fatal injury and the warranty will be voided as a result.
	Contact plates of the charger base and unit are not connected.	Make sure that the charger base is assembled on the unit properly so that their contact plates are touching.
	External adaptor is out of order	Contact dealer for replacement. WARNING! Using the wrong external adaptor will result in damaging the pool vacuum / battery and voiding the warranty as a result.

Pool vacuum does not move smoothly	Wheel is jammed	Clean out the debris from the wheel. Note: Do not attempt to take out the wheels.
------------------------------------	-----------------	--

Environmental Programmes, WEEE European Directive

	<p>Please respect the European Union regulations and help to protect the environment.</p> <p>Return non-working electrical equipment to a facility appointed by your municipality that properly recycles electrical and electronic equipment. Do not dispose them in unsorted waste bins.</p> <p>For items containing removable batteries, remove batteries before disposing of the product.</p>
	<p>© 2015 Kokido Development Ltd.</p> <p>All rights reserved. No part of this document may be reproduced or transmitted in any form or by any means, electronic, mechanical, photocopying, recording, or otherwise, without prior written permission of Kokido Development Ltd. (V1)</p>

If soft copy of this instruction manual is required, please contact our customer service by email:
customerservice@kokido.com