

# AIPER®

— bring vacation home —

## HANDHELD RECHARGEABLE POOL VACUUM

Original Instructions

**Aiper Pilot X1**

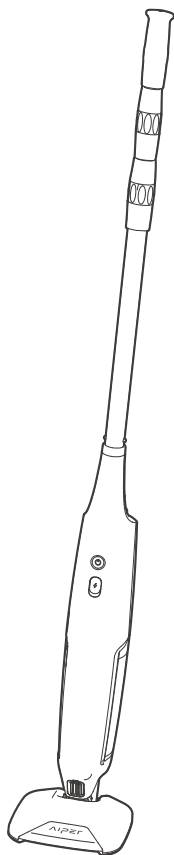

## User Manual

Thank you for choosing Aiper.

You've now joined millions who have already trusted Aiper to care for their pools and are enjoying the convenience of a pristinely clean pool.

This user manual will help you maintain your device and ensure it performs at its maximum efficiency for years to come. Please take a moment to read through it.

If you have any questions, please visit our website at [www.aiper.com](http://www.aiper.com) and contact our customer service team for assistance or more information.

### Aiper Customer Service:



Email: [service@aiper.com](mailto:service@aiper.com)



Scan the QR Code to Access  
Customer Support

## 1 IMPORTANT SAFETY INSTRUCTIONS

Please read this manual carefully and follow all warnings and instructions when using your Aiper Handheld rechargeable pool vacuum (hereinafter referred to as *device*). Failure to comply may result in electric shock, fire, or serious injury. Aiper is not liable for any losses or injuries caused by improper use of this device.

For your safety and the optimal performance of this device, please read and follow these instructions:

1. This device is not intended for use by persons (including children) with reduced physical, sensory or mental capabilities, or lack of experience and knowledge, unless they have been given supervision or instruction concerning use of the device by a person responsible for their safety.
2. This device can be used by children aged from 8 years and above and persons with reduced physical, sensory or mental capabilities or lack of experience and knowledge if they have been given supervision or instruction concerning use of the device in a safe way and understand the hazards involved.
3. Children shall not play with the appliance. Cleaning and user maintenance shall not be made by children without supervision.
4. Children should be supervised to ensure that they do not play with the device.
5. Ensure that children do not attempt to touch the device while it is operating.
6. Do not allow children to ride the device under any circumstance.
7. Do not operate the device with people or animals in the pool.
8. While operational, do not place your hands into any part of the device as this may result in injury.
9. Do not block the vacuum head with your hand or run it over your body, as this may cause injury.
10. Do not run your device out of the water as it may lead to over-heating.

11. A charger that is suitable for one type of battery pack may create a risk of fire when used with another battery pack.
10. **WARNING:** For the purposes of recharging the battery, only use the detachable supply unit provided with this device.
11. The lithium battery in this device is a DC 10.8V, 2600mAh, 3-cell battery, compatible with charger model GQ12-126119-HG. The battery must be removed and discarded according to local laws and regulations before disposing of the device.
12. This device can only be used with C1264C7 model lithium battery packs.
13. The device contains batteries that are only replaceable by skilled persons. To replace the device's battery, please contact Customer Service.
14. This device contains batteries that are non-replaceable. When the battery is at end of life, the device shall be properly disposed of.
15. Be aware of the risk of terminals of the battery-operated device or battery being short-circuited by metal objects.
16. In the event a damaged device produces an unfamiliar liquid, avoid contact with the liquid. If coming into contact with a foreign liquid, especially the eyes or other sensitive parts, immediately flush with water. Liquid ejected from a damaged battery may cause skin irritation or burns.
17. Do not expose the device or battery to fire or excessive temperature. Exposure to fire or temperature above 130°C (265°F) may cause explosion.
18. Remove the device from the charger, and turn OFF the power button to the device before removing the battery for disposal of the device .
19. The battery must be removed and discarded according to local laws and regulations before disposal of the device .
20. Please dispose of used batteries according to local laws and regulations.

21. Do not incinerate the device even if it is severely damaged. The batteries can explode in a fire.
22. Ensure your device is turned off before charging with the charger. While charging, your device should be kept in a cool, well-ventilated area. Do not cover your device while charging, as this may cause components to overheat.
23. **WARNING:** To reduce the risk of electric shock, replace damaged cord immediately.
24. If the power cord is damaged, it must be replaced or repaired by a qualified electrician or Aiper Customer Care to avoid any hazards.
25. The power supply is not to be repaired and not to be used any longer if it is damaged or defective.
26. Only certified professionals should disassemble the sealed drive kit of your device.
27. Only use as described in this manual. Only use attachments recommended or sold by the manufacturer.
28. Do not operate your device simultaneously with any other pool equipment, such as a pool filter, cleaner, or skimmer.
29. When putting your device into the water, the front of the device must face upwards and should never be placed upside down or thrown into the swimming pool.
30. Watch your steps and maintain balance when working near the poolside.
31. Do not drop, pierce the shell, or intentionally damage the device in any way, as this may void your warranty.
32. Disconnect the handheld rechargeable pool vacuum from the supply mains before carrying out user maintenance such as cleaning the filter.
33. The plug must be removed from the receptacle before cleaning or maintaining the charger.

34. When not using the charger for a long period of time, please unplug it.
35. When not in use, store the device indoors, in a cool, well-ventilated area.
36. CAUTION:
- FOR USE WITH SWIMMING & SPA POOLS ONLY.
  - DO NOT RUN PUMP DRY.
  - FOR USE ONLY WITH AUTHORIZED AIPER CHARGER, MODEL: GQ12-126119-HG.

SAVE THESE INSTRUCTIONS

## 2 Product Components

### 2.1 Package Contents



Pool Vacuum \* 1



Extension Pole \* 1

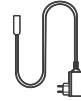

Charger \* 1



Wall-Mounted Holder \* 1



Cotton Filter  
(Complimentary) \* 1



User Manual \* 1

### 2.2 Component Overview

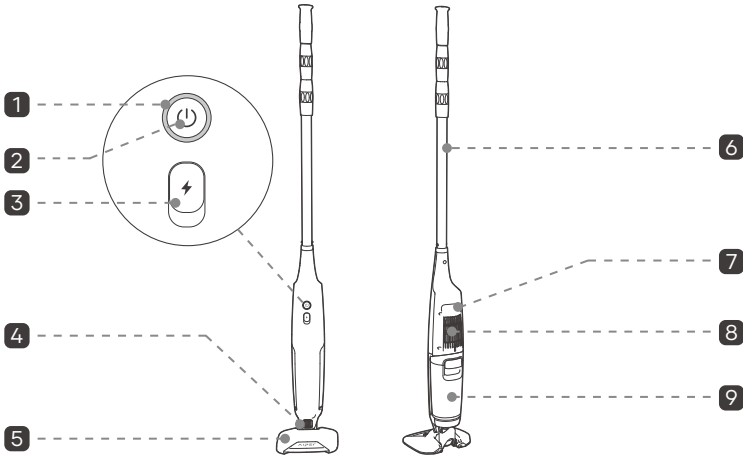

Pool Vacuum (Side View)

1 LED Indicator

4 Shallow Water Inlet

7 Holder Slot

2 Power Button

5 Suction Head

8 Pump Outlet

3 Charging Port

6 Extension Pole

9 Debris Bin

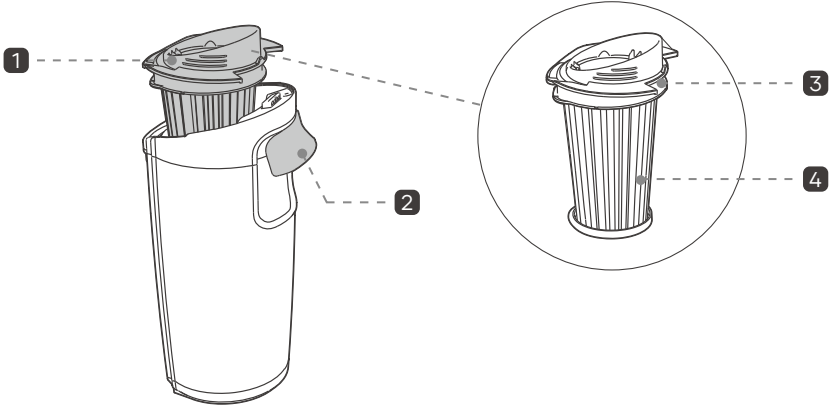

Debris Bin (Side View)

- 1 Filter
- 2 Debris Bin Release Handle
- 3 Filter Cover
- 4 Filter Screen

### 3 How to Use Your Aiper Pilot X1

#### 3.1 Operating Conditions

Please ensure the device is only used within the specified pool environments. Damage resulting from use outside these conditions will not be covered under warranty.

Water Temperature: 5-35°C (41-95°F)

pH Value: 7.0-7.8

Chlorine: Maximum 4 ppm

NaCl: Maximum 5000 ppm

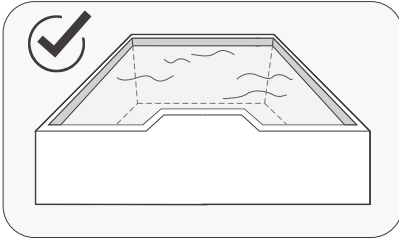

Pool Floors (Extension Pole Needed)

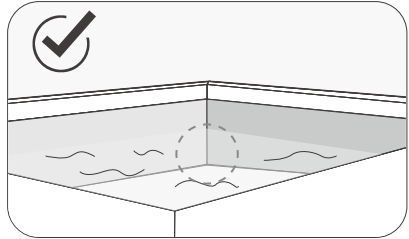

Pool Corners

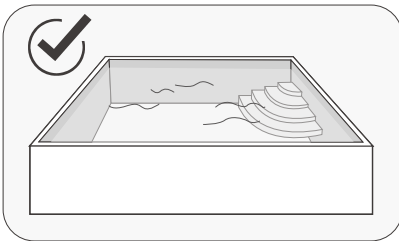

Pool Steps

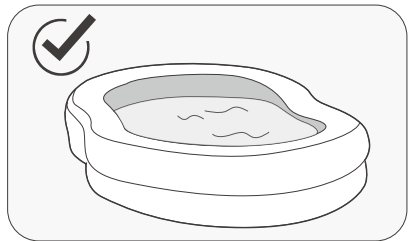

Inflatable Pools

### 3.2 Charging

**CAUTION:**

Please fully charge the device before using it to clean the pool.  
Do not charge the device in direct sunlight.

1. Charge the device indoors. Ensure that the device and the water in the debris bin are completely drained before charging.

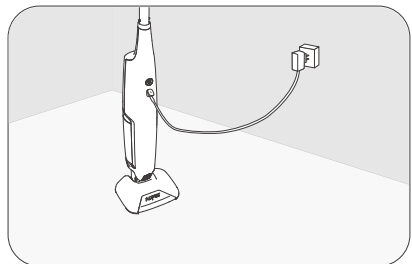

2. Open the device's charging port rubber plug to check and dry the area around the charging port thoroughly.

**CAUTION:** Charging in the presence of water can damage the charging port and may cause an electric shock hazard.

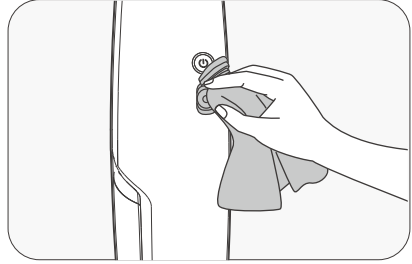
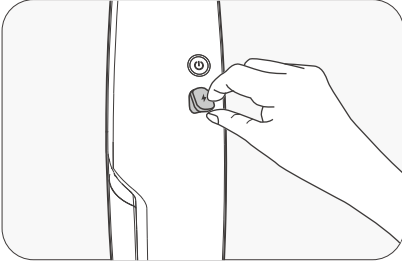

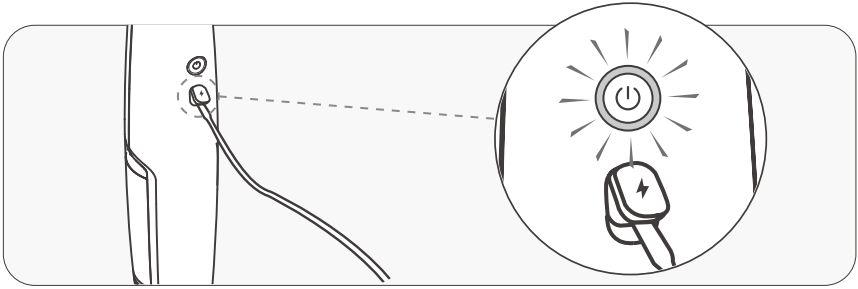

3. Insert the charging plug and connect it to an available power supply. During normal charging, the LED indicator will pulse.
4. The device takes approximately 2 hours and 30 minutes to fully charge. When fully charged, the LED Indicator will be constantly lit.

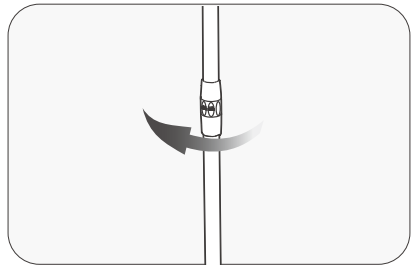
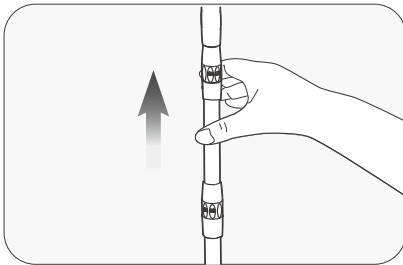
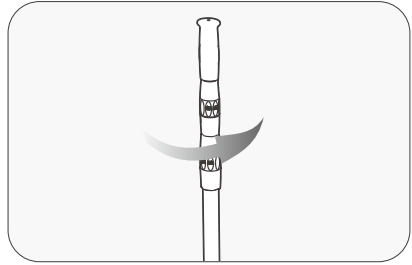
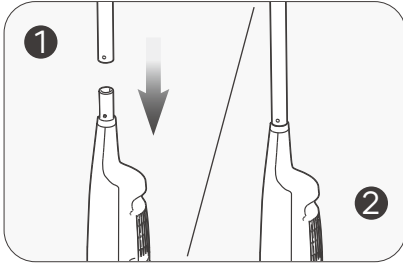

### 3.3 Cleaning Process

1. Attach and adjust the extension pole.  
 Insert and secure the extension pole into the socket on the top of the device.  
 Loosen the handle on the extension pole and then lengthen the extension pole.  
 Tightening the handle will secure the extension pole.



2. Press and hold  for 2 seconds to turn on the device. Immerse the device in water within 30 seconds to initiate vacuum suction cleaning.

**CAUTION:** Press and tightly secure the plug before immersing the device.

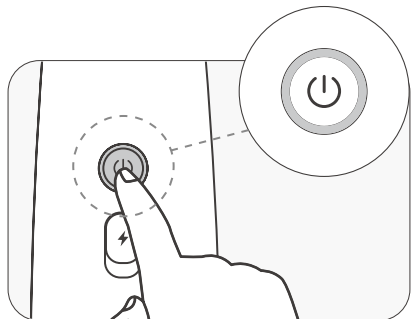
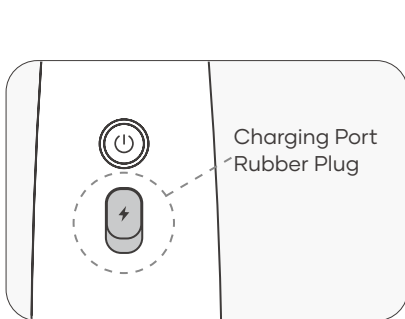

**Note:**

In the power-on status, press and hold  for 2 seconds to turn off the device.

### 3.4 Switching Modes

1. After powering on, the device will enter Deep Water Mode by default, and the LED Indicator will turn blue, which indicates that the device can start cleaning immediately.

To switch to Shallow Water Mode, briefly press . The LED Indicator will be flashing green for approximately 15 seconds. The device will start cleaning after the LED Indicator stops flashing.

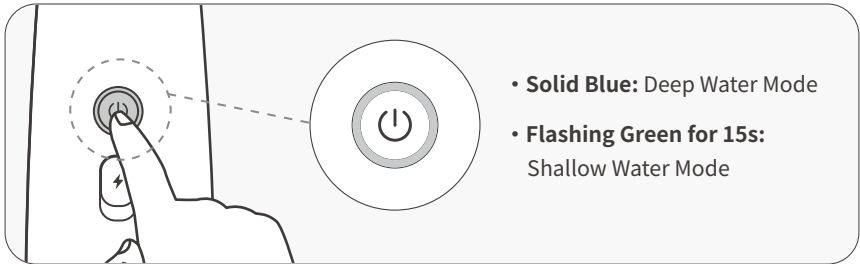

2. Deep Water Mode is designed for pool areas with a water depth above 50cm (20 inches). Shallow Water Mode is designed for pool areas with a water depth above 20cm (8 inches).

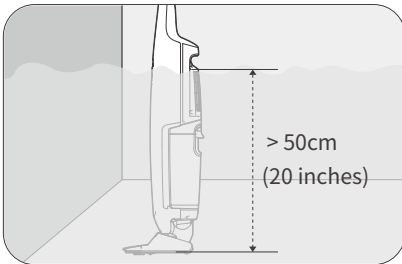

Deep Water Mode

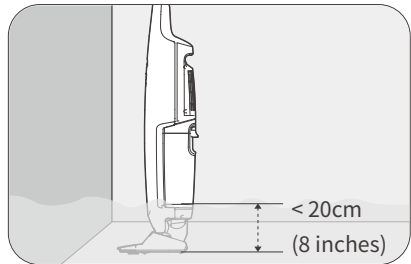

Shallow Water Mode

### 3.5 Using Cotton Filter

- **The cotton filter** is designed to filter fine particles, such as fine sand, dust, algae, etc. It is prone to clogging and may require frequent cleaning.
- **The filter screen** can only filter large particles, such as coarse sand, leaves, stones, etc.

Insert the cotton filter into the narrow end of the filter and push until it fully covers the filter screen, assembling a high-efficiency filter.

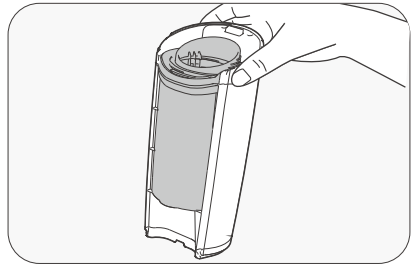
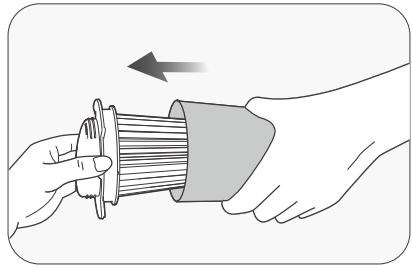
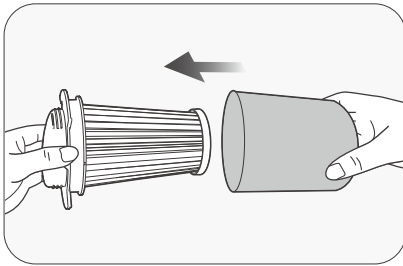

**Note:**

The cotton filter is a consumable material and should be replaced monthly for optimal performance.

## 4 Maintenance

### 4.1 Cleaning the Debris Bin

1. Remove the debris bin.

Pull the debris bin release handle, remove the debris bin from the side, and immediately invert the debris bin to quickly drain any water.

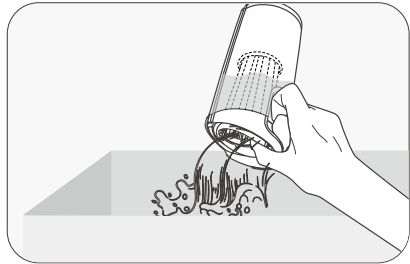
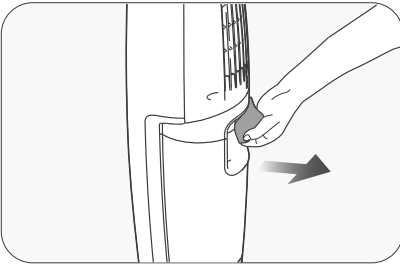

2. Clean the Filter.

After draining, pull out the filter by lifting it upward. Rinse the surface of filter with water and dry it.

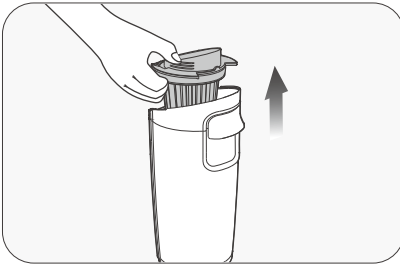

**Note:**

For optimal suction power, be sure to clean the filter thoroughly. The filter screen can only filter large particles, such as coarse sand, leaves, stones, etc. For fine particle filtration, use the included cotton filter.

3. Re-install the debris bin.

After installing the filter, put the debris bin back into the device and secure it until you hear a *click*, which indicates that the debris bin is properly installed in place.

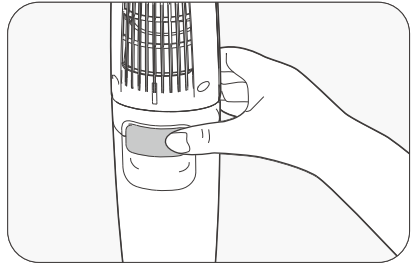
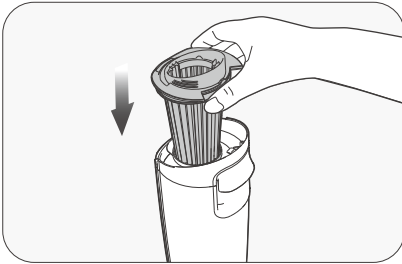

## 4.2 Storage

1. Holder Installation.

Install the holder on the wall with 2 matching screws, positioning it 60cm (23.6 inches) above the ground. Ensure that the holder is securely mounted before using it.

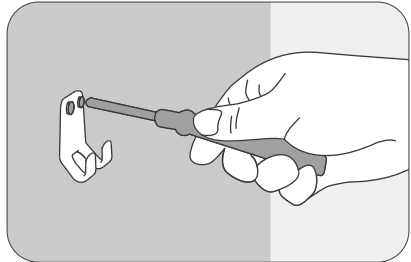
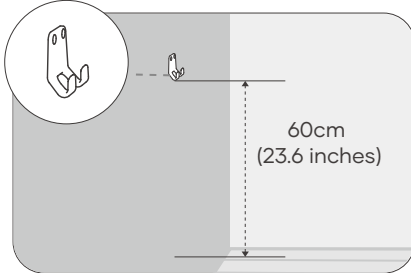

2. Hanging the Device.

Align the holder with the holder slot located in the device's back groove, and gently place the device onto the holder for hanging.

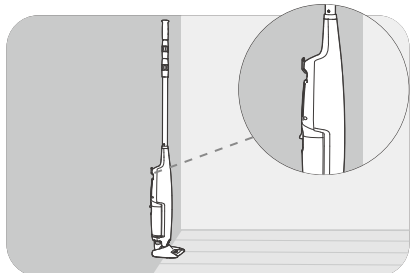
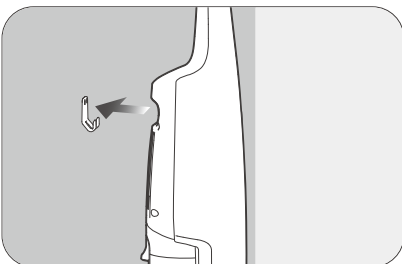

### 4.3 Replacing the Filter Screen

1. Firmly grip both ends of the filter and pull outward to remove the filter screen.
2. Insert the wide end of the new filter screen into the filter cover. Push until you hear a *click*, indicating that the new filter screen is assembled.

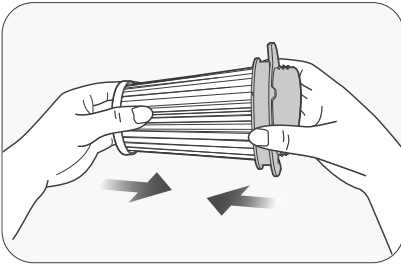
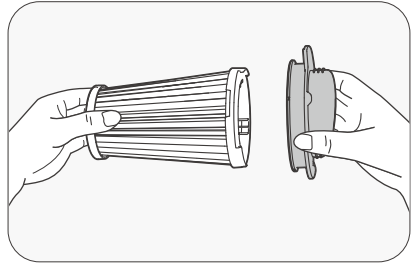
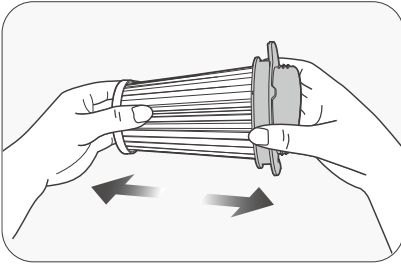









### 4.4 Powering Off and Storing Your Aiper

During off-seasons, such as winter or long vacations, when your Aiper device isn't in use, follow these steps to keep it in top shape:

1. Fully charge the device before storing it. Ensure that the device is turned off and disconnected from the charger before storing.
2. Thoroughly clean the entire device, including the top and bottom shells, wheels and brushes to remove any dirt.
3. Dry the device with a tissue or soft cloth, and ensure the charging port cover is properly closed.
4. Store the device in its original packaging in a cool, dry, and well-ventilated place.
5. Recharge the battery every six months to maintain its health.

## 5 Specifications

Model: HAH3
Rated Input: 12.6V = 1.19A
Charger Model: GQ12-126119-HG
Charger Input: 100-240V ~, 50-60Hz, 0.4A
Charger Output: 12.6V = 1.19A
Charging Time: 2.5 Hours
Suction Power: 4800 LPH (1260 GPH)
Battery Pack Life: Up to 45 Minutes
Battery Pack Capacity: 2600mAh (28.08Wh)
Battery Pack Voltage: 10.8V
Water Protection Rating: IPX8
Charger Protection Degree: IP20
Max Water Depth: 3m (10 ft)

	Direct current.
	Alternating current.
	Class II equipment.
	Switch mode power supply.
	Polarity of d.c. power connector.
	Short-circuit-proof safety isolating transformer.
	For indoor use only.
	Read user's manual.

## 6 LED Indicator

Device Status	Device Status Indicators	Status Description
Device is working.	Solid Blue.	Performing Deep Water Mode.
	Flashing Green.	Preparing pump startup.
	Solid Green.	Performing Shallow Water Mode.
	Solid Red.	Low battery. Charge the device.
	Flashing red for 5 times, then device automatically shutting down.	Low battery / Device malfunction.
Device is charging.	Pulsing Blue.	Charging.
	Solid Blue.	Fully charged.
	Solid Red.	Battery failure.

## 7 Troubleshooting

NO.	Malfunction	Possible Causes	Solutions
1	Device does not turn on, flashing red.	Low battery.	Charge for at least 30 minutes and try again.
2	Device not charging.	Charging plug not connected in place.	Reconnect the plug, ensuring that the metal contacts are connected firmly. Wait a few minutes and retry.
		Charging plug damaged. / Charging port damaged.	If the plug is correctly connected but the device cannot charge, the plug or the charging port might be damaged. Contact Aiper customer service.
		Battery temperature too high / low.	Only charge the device in 0-45°C (32-113°F) environment.
		Battery over-discharged from long inactivity.	Follow the <i>Powering Off and Storing Your Aiper</i> section in the <i>Maintenance</i> guide for proper storage of the device. If the device won't charge due to extended non-use, please contact Aiper customer service.

NO.	Malfunction	Possible Causes	Solutions
3	No suction power / Lower suction power.	Filter not installed.	Check if the filter is correctly installed in the debris bin.
		Filter is clogged.	Remove the filter and rinse it thoroughly.
4	Device not working in shallow water.	Device is in the Deep Water Mode instead of Shallow Water Mode.	Press (⏮) briefly to switch to Shallow Water Mode. Wait 15 seconds in shallow water. Device will start cleaning after the LED Indicator stops flashing.
		Water depth too low in shallow water.	Ensure that the water depth is at least 20cm (8 inches) for operation.
		Filter not correctly installed.	Ensure that the filter is in the debris bin. Re-install the debris bin until you hear a <i>click</i> , which indicates that the debris bin is in place.
5	Device automatically shutdown.	Low battery. Automatic shutdown soon.	Fully charge and try again.
		Device cannot work due to insufficient water depth. Automatic shutdown soon.	In Deep Water Mode, ensure that the water depth is at least 50cm (20 inches). In Shallow Water Mode, ensure that the water depth is at least 20cm (8 inches). Device will automatically shutdown if the water depth is insufficient.

## 8 Warranty

This product has passed quality control and safety test conducted by our technicians.

1. This product comes with a warranty that covers your item's battery and motor from the date of purchase. The respective country's legal provisions for warranty conditions shall apply accordingly.
2. This warranty is voided if the product has been altered, misused, or has been repaired by unauthorized persons.
3. This warranty extends only to manufacturing defects and does not cover damage resulting from the mishandling of the product by the owner.
4. The order number or record of purchase must be presented at the request of any repair claim during the warranty period.
5. This is an additional warranty offered by AIPER INTELLIGENT SARL, 43-47 avenue de la Grande Armée, 75116 Paris, France. This warranty does not affect the free of charge remedies for lack of conformity that the consumer holds against the seller, according to law.
6. Warranty Email: [service@aiper.com](mailto:service@aiper.com)

### European Union Compliance Statement

#### Information on Disposal for Users of Waste Electrical & Electronic Equipment

##### Correct Disposal of this Product



This symbol on the product or on its packaging indicates that used electrical and electronic products should not be mixed with unsorted municipal waste. For proper treatment, it is your responsibility to dispose of your waste equipment by arranging to return it to designated collection points.

Disposing of this product correctly will help save valuable resources and prevent any potential negative effects on human health and the environment, which could otherwise arise from inappropriate waste handling.

To return your used device, please use the return and collection systems or contact the retailer where the product was purchased, which is free of charge, please contact your local authority for further details of your nearest designated collection point.

Penalties may be applicable for incorrect disposal of this waste, in accordance with your national legislation.

**Information on Disposal for Users of used batteries**



This symbol means that batteries and accumulators, at their end-of-life, should not be mixed with unsorted municipal waste. Your participation is an important part of the effort to minimize the impact of batteries and accumulators on the environment and on human health. For proper recycling you can return this product or the batteries or accumulators it contains to your supplier or to a designated collection point, which is free of charge.

Disposing of this product correctly will help save valuable resources and prevent any potential negative effects on human health and the environment, which could otherwise arise from inappropriate waste handling.

Penalties may be applicable for incorrect disposal of this waste, in accordance with your national legislation. there are separate collection systems for used batteries and accumulators.

Please, dispose of batteries and accumulators correctly at your local community waste collection/recycling center.



The CE symbol confirms that this product conforms to the below mentioned norms and regulations.

## EU declaration of conformity

Name and address of the manufacturer:

Shenzhen Aiper Intelligent Co., Ltd.

Units 3201, 3203A and 3205, 32nd Floor, Block C, Phase 2 Galaxy World, Minle Community, Minzhi Street, Longhua District, Shenzhen, Guangdong, China,

Name and address of the authorised representative:

AIPER INTELLIGENT SARL

43-47 avenue de la Grande Armée, 75116 Paris, France

This declaration of conformity is issued under the sole responsibility of Shenzhen Aiper Intelligent Co., Ltd.

Type of Object : Handheld rechargeable pool vacuum

Brand:

Model: HAH3

Specification: Electrical appliances for household and similar purposes

The object of the declaration described above is in conformity with the following Directives:

EMC	Directive 2014/30/EU
LVD	Directive 2014/35/EU
RoHS	Directive 2011/65/EU
WEEE	Directive 2012/19/EU
REACH	Directive 1907/2006/EC

The object of the declaration described above has been assessed and found compliance with the following harmonised standards and technical references:

EN 60335-2-29: 2004 + A2:2010 + A11:2018

EN 60335-1: 2012 + AC:2014 + A11:2014 + A13:2017 + A1:2019 + A14:2019 + A2:2019

EN 62233: 2008

EN 55014-1: 2017+A1:2020

EN 55014-2: 2015

EN IEC 6100032: 2019

EN 61000-3-3: 2013+A1:2019

IEC 60529: 1989+A1:1999+A2:2013

**Notes on Usage**

- This device is designed for use in all countries of the European Union and in Switzerland, Norway, Liechtenstein and Iceland.

**SUPPLEMENTARY INFORMATION:**

The object of this declaration has been tested and found to comply with the electromagnetic compatibility (EMC) limits for a Class B digital device pursuant to the listed directives, regulations and standards. These limits are designed to provide reasonable protection against harmful interference when the equipment is operated in a residential or business environment. The equipment was tested in a typical configuration.

Units 3201, 3203A and 3205, 32nd Floor, Block C, Phase 2 Galaxy World, Minle Community, Minzhi Street, Longhua District, Shenzhen, Guangdong, China,	<i>Kelly. Pan</i>
Place of issue	Signed for and on behalf of Shenzhen Aiper Intelligent Co., Ltd.
Nov 20th, 2024	Kelly.Pan
Date of issue	Full printed Name
240102	Certification Engineer
AIPER document control tracking number	Position/Title

For EU Declaration of Conformity information in multiple languages, visit <https://eu.aiper.com/aiper-europe-doc-user-manual/>

**Manufacturer**

Shenzhen Aiper Intelligent Co., Ltd.

Units 3201, 3203A and 3205, 32nd Floor, Block C, Phase 2 Galaxy World, Minle Community, Minzhi Street, Longhua District, Shenzhen, Guangdong, China, 518129

CN Tel: +86075521018957

Email: [service@aiper.com](mailto:service@aiper.com)

[www.aiper.com](http://www.aiper.com)



Points de collecte sur [www.quefairedesdechets.fr](http://www.quefairedesdechets.fr)  
Privilégiez la réparation ou le don de votre appareil !



Points de collecte sur [www.quefairedesdechets.fr](http://www.quefairedesdechets.fr)  
Privilégiez la réparation ou le don de votre appareil !

**AIPER®**

— bring vacation home —

[www.aiper.com](http://www.aiper.com)